

THRU-ROOF AND THRU-WALL ASSEMBLIES

ALL ITEMS



The following pages show various thru-roof and thru-wall assemblies using threaded rods, nuts, and washers, along with a combination of connectors as described below and as indicated by the letters added to the part number. (For complete description of the connectors listed, refer to index for catalog page on each item being considered). Cable connectors are for main sized cable.

"CP" means copper base center nut No. 803
(specify 3/8", 1/2", or 5/8" threads for point) - 1.6 oz.

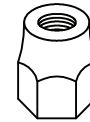

"AP" means aluminum base center nut No. A803
(specify 1/2" or 5/8" threads for point) - 0.4 oz.

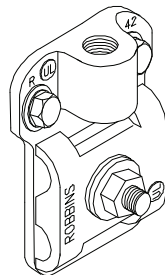

"CT" means copper tee base No. 42AN - 12.9 oz.

"AT" means aluminum tee base No. A42AN - 4.6 oz.

"CD" means copper clamp No. 55D - 6.1 oz.

"AD" means aluminum clamp No. A55D - 2.4 oz.

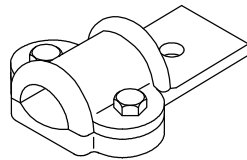
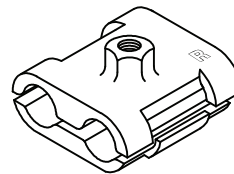

"CL" means copper lug No. 55B - 8.2 oz.

"AL" means aluminum lug No. A55B - 2.6 oz.

"CS" means copper straight connector No. 42 - (5.8 oz.) or No. 42L - (10.4 oz.)
(specify size of cable being used)

"AS" means aluminum straight connector No. A42L - 3.8 oz.



ROBBINS LIGHTNING, INC.

124 EAST SECOND STREET PHONE (660) 582-3156 FAX (660) 582-3039 P.O. BOX 440 MARYVILLE, MISSOURI 64468-0440