

## STRAP RIDGE POINT BASE



FOR CLASS I  
STRUCTURES  
ONLY

Copper or aluminum strap point base for use on ridge, flat or sloping roof – shipped formed for roll ridge but may be formed easily to fit roof – copper base 0.064" thick, aluminum base 0.100" thick – 2-1/2" wide, 12" long – four anchor holes for nails or screws – crimp type cable holder with 2" contact for cables. For main sized cables.

Specify diameter of point – 3/8", 1/2", or 5/8".

**Cat. No. 45B** – Copper - 12.6 oz.

**Cat. No. A45B** – Aluminum - 5.6 oz.

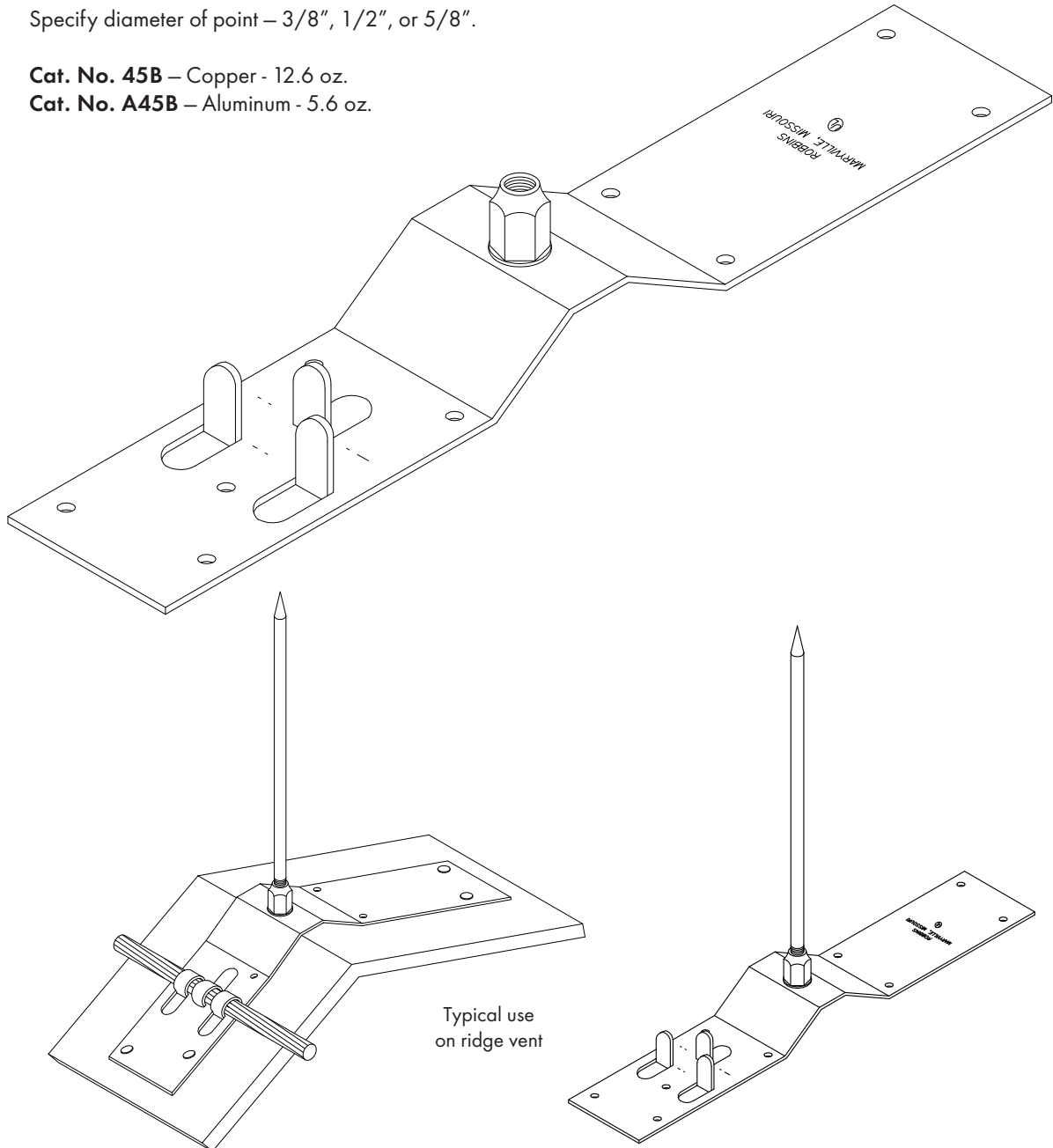

# ROBBINS LIGHTNING, INC.

124 EAST SECOND STREET PHONE (660) 582-3156 FAX (660) 582-3039 P.O. BOX 440 MARYVILLE, MISSOURI 64468-0440

