

SPECIAL POINTS

TAPERED GOVERNMENT POINT

Cast bronze or aluminum point with full length taper – 1/2" male thread to fit all point bases – available in bronze finish (No. 26), nickel plated bronze (No. 26A) or aluminum (No. A26) – length from hub – 16".

Cat. No. 26 – Copper - 1 lb.



Cat. No. 26A – Copper - 1 lb.

Cat. No. A26 – Aluminum - 5 oz.

TUBULAR POINT WITH DOWEL ADAPTER

Tubular copper or aluminum point with dowel adapter securely clamped to lower end with male thread for all point bases – copper points bright nickel tipped. For Class I only.

Copper - 5/8" diameter x 0.032" thick

Cat. No. 27 – 12" long - 6.3 oz.

Cat. No. 27A – 15" long - 7.2 oz.

Cat. No. 27B – 18" long - 8.1 oz.

Cat. No. 27C – 24" long - 10 oz.



Aluminum - 0.84" diameter x 0.109" thick

Cat. No. A27 – 12" long - 5.5 oz.

Cat. No. A27A – 15" long - 6.6 oz.

Cat. No. A27B – 18" long - 7.1 oz.

Cat. No. A27C – 24" long - 10.1 oz.

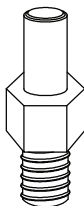
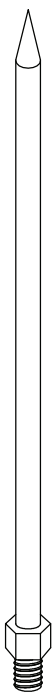

DOWEL ADAPTER

Brass or aluminum dowel adapter for use with tubular points – 1/2" male thread.

Cat. No. 720 – Copper - 2.6 oz.

Cat. No. A720 – Aluminum - 0.8 oz.

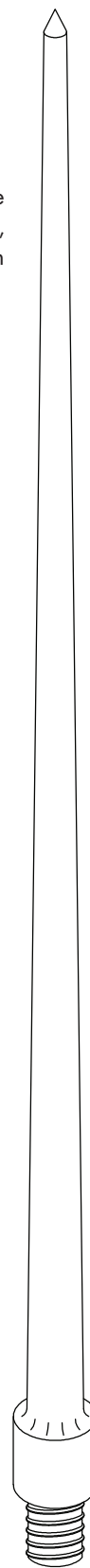

ROBBINS LIGHTNING, INC.

124 EAST SECOND STREET PHONE (660) 582-3156 FAX (660) 582-3039 P.O. BOX 440 MARYVILLE, MISSOURI 64468-0440

